

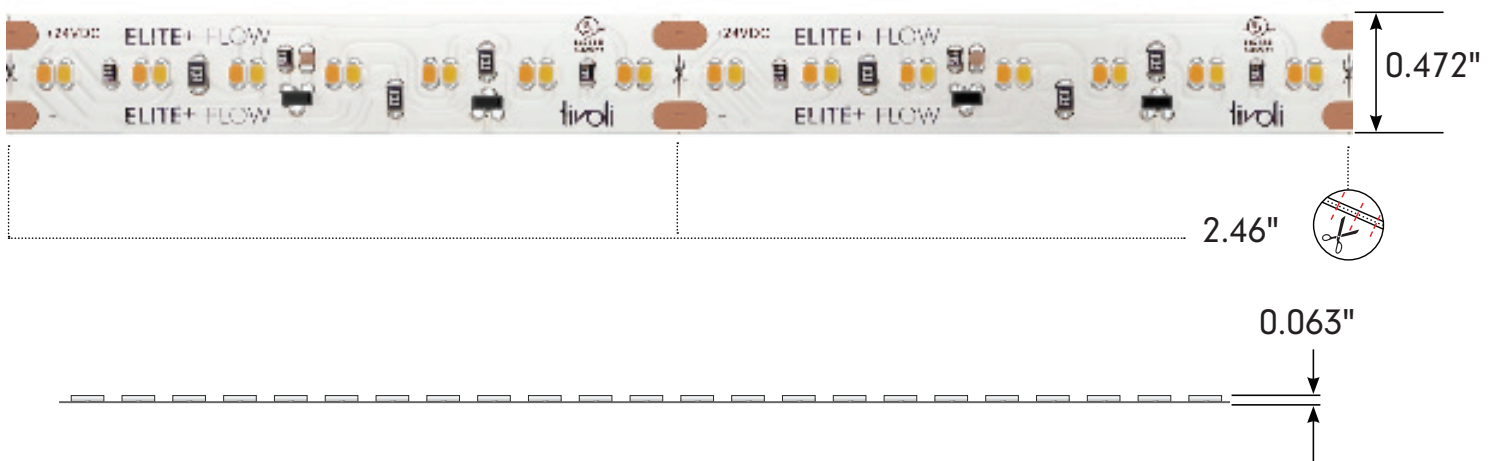

Project: _____ TYPE: _____

- Dim to warm from 1800K - 3000K
- Low bin tolerance with a 2 Step McAdam Elipse standard
- High efficacy value
- Includes Tivoli's eXo shield coating
- Factory soldered lead wire
- Standard IP54 damp rated and IP67 wet location available
- Multiple mounting channel options
- Low lead times
- 5 Year warranty

Dimensions



Order Guide

PRODUCT CODE	TYPE	INSTALL	LED COLOR	*MAX RUN	VOLTAGE
TPLEP	FL	I	01		24
TPLEP = TivoTape ELITE Plus+	FL = Flow	I = Indoor	01 = 1800K - 3000K	MR = Max Run	24 = 24V DC

* Optional - Leave blank if not needed

Note: A layout/drawing must accompany each order showing run length and location

Note: Runs with LEAD-C are rounded **up** to next cut interval (unless otherwise specified)

Note: Runs with LEAD-D are rounded **down** to next cut interval (unless otherwise specified)

Specification

Based on full brightness @ 3000K	
Kelvin Temperature	3000K
Lumens/ft	443
Efficacy (Lm/W)	97
CRI	91.7
Measured Power W/ft	4.6
Listed Power W/ft.	4.6
Max Run	20'

Electrical	
Input Voltage	24V
Dimming	MLV/ELV/0-10V/DMX
Physical	
LED Package	2216
LEDs/ft	68
Adhesive	3M VHB Tape
Copper Trace	3 Ounce
Dimensions	0.472" (12mm)
Cut Increments	2.46" (62.48mm)
Operating Temperature	-40°F (-40°C) ~ +140°F (+60°C)
Certification and Testing	
Certification	UL Listed, CE
Lumen Maintenance (L70)	60,000 hrs
Binning Tolerance	2 Step MacAdam Elipse
Environment	IP54 Damp Location, Conformal eXo Shield
Warranty	5 years

Power Leads and Jumpers (Installed by Tivoli's certified solderers)

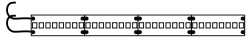

TPL-I-LEAD-2-C
LEAD/END
24" standard 2 conductor
18AWG lead wire factory
attached to one end of tape

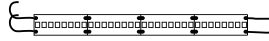

TPL-I-LEAD-2-D
LEAD/LEAD
24" standard 2 conductor
18AWG lead wire factory
attached to both ends of tape

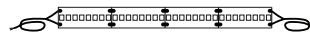

TPL-I-XEP-2
EXTRA LEAD WIRE
Additional factory attached
18AWG lead 2 wire to extend
lengths of LEAD-C and LEAD-D
up to 20 ft. max
Sold per foot

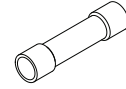

TPL-I-CONN
18-22AWG BUTT CONNECTORS
Used to interconnect factory
attached lead wires.
Sold individually.

Compatible Extrusions

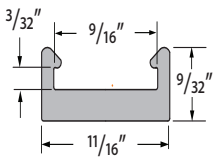

MCHAN-8-LP
Low profile NO LENS OPTION
clear polycarbonate, length 8'

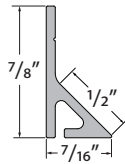

TPL-I-45-MCH-8-S
White PVC, 45° NO LENS
length 8'

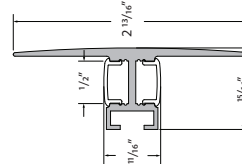

DWAR-CHAN-SLV-6.5
Anodized Aluminum Extrusion,
available in 6.5' lengths

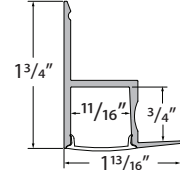

EDGE-CHAN-SLV-6.5
Anodized Aluminum Extrusion,
available in 6.5' lengths

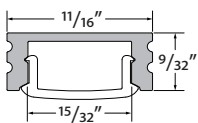

MINI-CHAN-SLV-6.5
Anodized Aluminum Extrusion,
available in 6.5' lengths

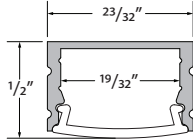

MOFT-CHAN-SLV-6.5
Anodized Aluminum Extrusion,
available in 6.5' lengths

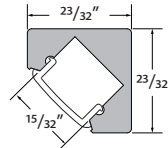

DYER-CHAN-SLV-6.5
Anodized Aluminum Extrusion,
available in 6.5' lengths

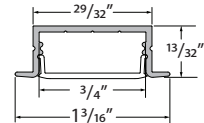

WRNR-CHAN-SLV-6.5
Anodized Aluminum Extrusion,
available in 6.5' lengths

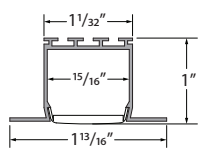

NOYS-CHAN-SLV-6.5
Anodized Aluminum Extrusion,
available in 6.5' lengths

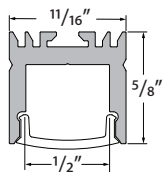

VALN-CHAN-SLV-6.5
Anodized Aluminum Extrusion,
available in 6.5' lengths

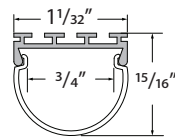

DOME-CHAN-SLV-6.5
Anodized Aluminum Extrusion,
available in 6.5' lengths

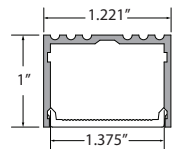

ALTN-CHAN-SLV-6.5
Anodized Aluminum Extrusion,
available in 6.5' lengths

Compatible Extrusions

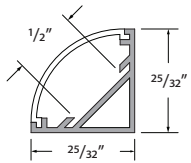

MRS-CHAN-SLV-6.5
Anodized aluminum extrusion
available in 6.5' length

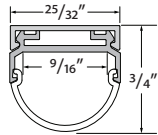

HRIZ-CHAN-SLV-6.5
Anodized aluminum extrusion
available in 6.5' length

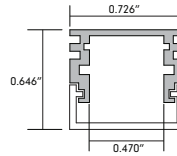

ASTR-CHAN-SLV-6.5
Anodized aluminum extrusion
available in 6.5' length

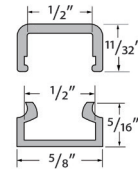

INF-X-CHAN-8
X = C (clear), **F** (frosted)
PC extrusion,
available in 8' lengths

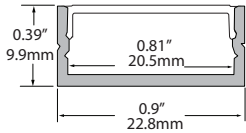

COTA-CHAN-SLV-6.5
Anodized Aluminum Extrusion,
available in 6.5' lengths

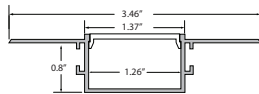

CARU-CHAN-SLV-6.5
Anodized aluminum extrusion,
available in 6.5' lengths

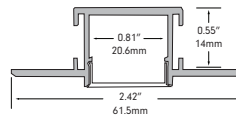

HAYS-CHAN-SLV-6.5
Anodized Aluminum Extrusion,
available in 6.5' lengths

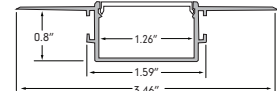

GLOR-CHAN-XXX-6.5
Anodized Aluminum Bendable
Extrusion,
available in 6.5' lengths

In-Wall Controls



TVOQ-1-WH
White



TVOQ-10-XX-7
XX = **BK** (Black), **WH** (White)



TVOQ-2-BK
Black

Power Supplies

INFINITY - MLV / ELV / 0-10V / PWM / TRIAC

DESCRIPTION	CAT NO	APPLICATION	PRIMARY VOLTAGE	SECONDARY VOLTAGE	CIRCUIT BREAKERS	MAX LOAD	MIN LOAD	CIRCUIT CAPACITY
Infinity Series Class 2 Transformer	INF-J-30-1-1.3-24	Indoor / Outdoor	100 - 277V AC	24V DC	1	30W	3W	1.3A
	INF-J-60-1-2.5-24				1	60W	6W	2.5A
	INF-J-96-1-4-24				1	96W	9W	4A
	INF-J-192-2-4-24				2	2x96W	2x9W	2x4A
	INF-J-288-3-4-24				3	3x96W	3X9W	3x4A

ADUL/ADNM - 0-10V DIMMING

DESCRIPTION	CAT NO	APPLICATION	PRIMARY VOLTAGE	SECONDARY VOLTAGE	CIRCUIT BREAKERS	MAX LOAD	CIRCUIT CAPACITY
ADUL/ADNM Series Class 2 Transformer	ADNM-90-1-4-24-DOT	Indoor / Outdoor	100-277V AC 50/60 HZ	24V DC	1	90W	3.75A
	ADUL-120-1-4-24-DOT				1	96W	4A
	ADUL-240-2-4-24-DOT				2	2x96W	2x4A
	ADUL-320-3-4-24-DOT				3	3x96W	3x4A

Recommended Dimmers

DIMMING - 0-10V

DESCRIPTION	CAT NO	APPLICATION	INPUT VOLTAGE	OUTPUT VOLTAGE	MAX LOAD
0-10V Dimmer	DIM-LD-010	Indoor	12V/24V DC	12V/24V DC	30 mA max. output (sink only)