

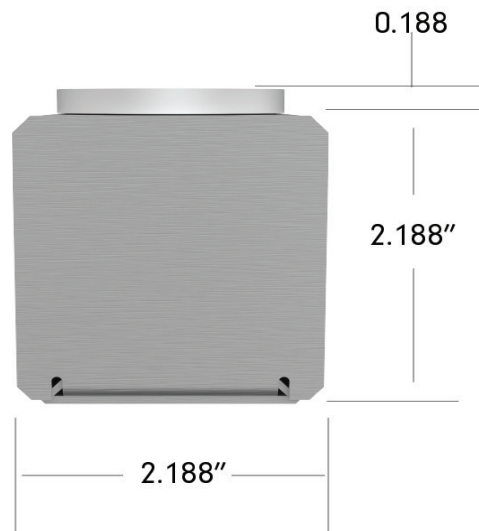

Project: \_\_\_\_\_ TYPE: \_\_\_\_\_

- UL wet weather seal option available
- Optional switch
- Available GFCI or standard dual 3 prong outlet
- Heavy-gauge extruded aluminum
- Available in 6", 12", 18" and 24" OC standard spacing
- 2.188" x 2.188" Standard Profile extrusion available
- Wiring and components are concealed
- Anti-corrosion coated (custom finished on request)
- Available in: Satin Aluminum, Powder Coated White or Powder coated black
- Custom radial bends
- Optional 4 channel chase wiring is available
- Pre-wired for quick and easy installation
- 7/8" diameter knockouts on mounting side (custom optional end cap knockouts)

Dimensions



**Order Guide**

AC Standard Architectural Channel maximum length 12'

PRODUCT CODE	SOCKET TYPE	LAMP SPACING	FINISH	OPTIONAL CHASSING	OPTIONAL WEATHER SEAL
<b>AC</b> AC = Standard	<b>MB</b> MB = Medium Base	<b>06</b> = 6" OC <b>12</b> = 12" OC <b>18</b> = 18" OC <b>24</b> = 24" OC	<b>SA</b> = Satin Aluminum <b>BK</b> = Black Powder Coat <b>WH</b> = White Powder Coat	<b>CC1</b> = 120V 4 Channel Chasing <b>CC2</b> = 220/240V 4 Channel Chasing	<b>WS1</b> = Weather Seal (Required for Outdoor Applications)

**Specification**

Electrical	
Operating Voltage	120V AC/ 240V AC
Physical	
Dimensions	AC Standard 2.188" W x 2.188" H (without bulb)
Socket Spacing*	6", 12", 18" and 24" OC
Order increments	1' (12' max)
Housing	Aluminum
American Wire Gauge	20 AWG
Mounting	Surface Mount, Suspended
Knock-out Holes	Every 24" along mounting face of channel
Sockets	Medium Base, E26/E27
Lamps (By others)	60W max
Certification and Testing	
Certification	cULus
Environment	Dry/Wet Location
IP Rating	IP54/IP65
Warranty	5 Years

\*Custom lamp spacing available (consult factory)  
\*\*Custom paint or anodizing available (consult factory)

**Compatible Tivolite**

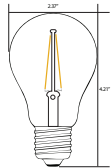

**TVLT-A19-X-X-26-XX-120**  
**X** (Filament Count) = 1, 2, 6  
**X** = F (Frosted), **V** (Vintage),  
**C** (Clear)  
**XX** (CCT) = 22, 24, 27  
 A19 Tivoli Bulb

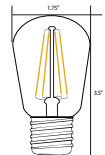

**TVLT-S14-X-X-26-XX-120**  
**X** (Filament Count) = 1, 2, 4, 6  
**X** = F (Frosted), **V** (Vintage),  
**C** (Clear)  
**XX** (CCT) = 22, 24, 27  
 S14 Tivoli Bulb

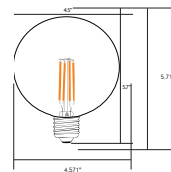

**TVLTPET-G120-4-C-26-XX-120**  
**XX** (CCT) = 24, 27  
 G125 PET Tivoli Bulb

**Accessories and Joiners**

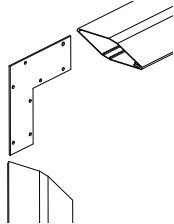

**AC-90**  
Flat 90° (Standard)  
Internal 90° Bracket

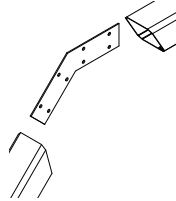

**AC-45**  
45° Bracket (Standard)  
Internal 45° Bracket

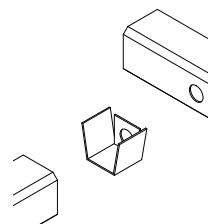

**AC-T**  
T Bracket (Standard)  
internal T-bracket

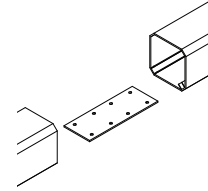

**AC-180**  
Internal Connector (Standard)

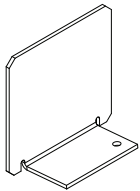

**AC-EC-XX**  
**XX = SA** (Satin Aluminum),  
**PW** (Powder Coated White),  
**PB** (Powder Coated Black)  
End Caps  
Standard Profile

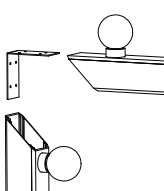

**AC-90-OI**  
90° (Standard Outside/Inside)  
Internal 90° Bracket

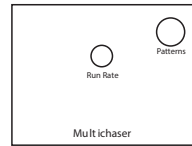

**CC4-120V**  
120V 1-4 Channel  
Chase Controller with  
adjustable chase speed rate  
of 1-30 step per/sec.

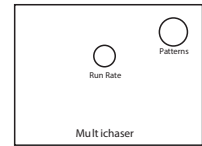

**CC4-220V**  
220V-240V 1-4 Channel  
Chase Controller with  
adjustable chase speed rate  
of 1-30 step per/sec.

**Channel Configurations**

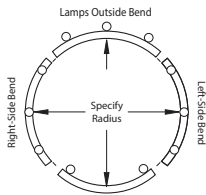

**RADIUS**  
Radius bend set up charge  
(Over 3' Radius)  
Note: Indicate lamp position at  
time of ordering

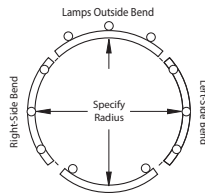

**RADIUS-3**  
Radius bend set up charge  
(Under 3' Radius)  
Note: Indicate lamp position at  
time of ordering

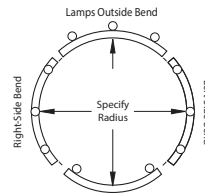

**R-UNITS**  
Radius unit charge, Per 8' Max  
length  
Note: Indicate lamp position at  
time of ordering

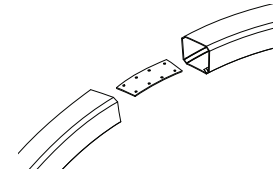

**AC-RADIUS**  
Internal Bracket

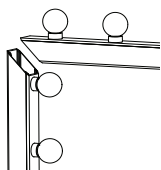

**AC-MITER**  
Factory Miter Cut