

CAT: FEET:

TYPE: PROJECT:

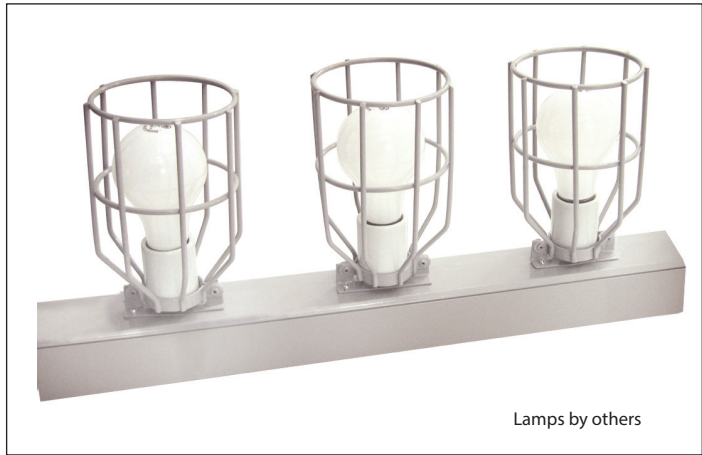

“WB” Wire basket medium based architectural channel is an industry standard. Wire guarded medium based (E26) sockets are installed into high grade aluminum extruded channel, which provides lightweight rigidity and a solid connection to your structure. Wire baskets in the past protected talent from the heat of incandescent lamps. Halogen medium based lamps can be inserted and are still available. Specify WB – Architectural channel when using halogen lamps or glass LED bulbs for make-up mirror type applications.

Features

- Riveted Wire Guard meets NEC #520.72 standard
- Heavy-gauge extruded aluminum
- Available in 6”, 9”, 12” and 18” OC standard spacing
- Wiring and components are concealed
- Anti-corrosion coated (Custom Finished on Request)
- Custom radial bends
- 2 3/16” x 2 3/16” Standard Profile extrusion available
- Optional 4 Channel chase wiring is available
- Configurable for freight optimization
- Pre-wired for quick and easy installation
- Knock-out holes for screws are provided every 24”
- 7/8” diameter knockouts on mounting side (custom optional end cap knockouts)

Mounting

Knock-out holes for screws have been provided every 24” along mounting face of channel.

Applications

Ideal for make-up mirror illuminated frames in public space, greenroom, backstage type applications. Use for indoor applications only.

Warranty

5 years



Technical Information

Socket Spacing*	6”, 9”, 12” and 18” OC
Order Increments	1’
Operating Voltage	120V AC / 240V AC
Material	Aluminum Alloy
Finishes**	Satin or Polished Aluminum, Black or White Powder Coated
Sockets	Medium Base E26/E27
Lamps (By others)	100W max

*Custom lamp spacing available (consult factory)

**Custom paint or anodizing available (consult factory)

Profile Dimensions

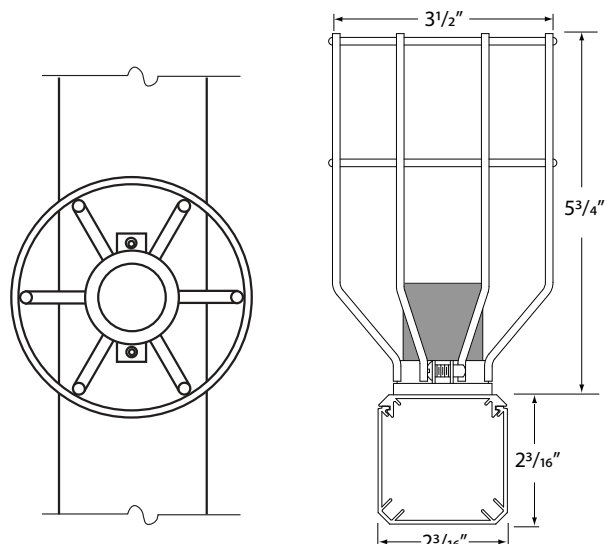

Ordering Information

AC Standard Architectural Channel maximum length 12’

PRODUCT CODE	SOCKET TYPE	LAMP SPACING	FINISH
AC	WB		
AC = Standard Architectural Channel	WB = Wire Guard Base	06 = 6” OC 09 = 9” OC 12 = 12” OC 18 = 18” OC	PA = Polished Aluminum* SA = Satin Aluminum BK = Black Powder Coat WH = White Powder Coat CS = Custom

*Consult Factory for extended lead time.

Pattern Accessories and Joiners

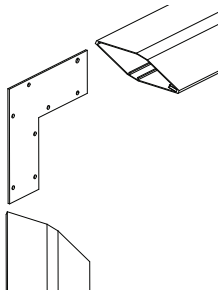

INTERNAL 90° BRACKET
AC-90
Flat 90 (Standard)

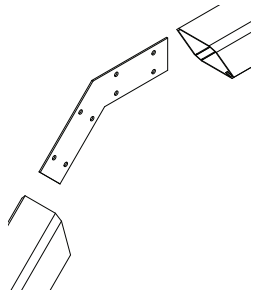

INTERNAL 45° BRACKET
AC-45
45° Bracket (Standard)

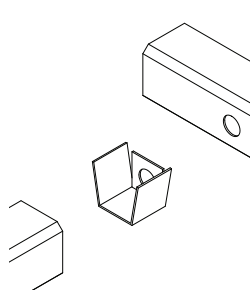

INTERNAL T-BRACKET
AC-T
T Bracket (Standard)

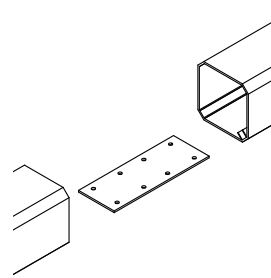

INTERNAL CONNECTOR
AC-180
Internal Connector (Standard)

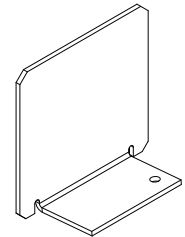

END CAPS
STANDARD PROFILE
AC-EC-SA
Satin Aluminum
AC-EC-PA
Polished Aluminum
AC-EC-PW
Powder Coated White
AC-EC-PB
Powder Coated Black

Channel Configurations

Factory Radius

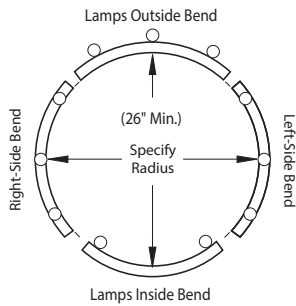

RADIUS CHARGES

- RADIUS**
Radius bend set up charge (Over 3' Radius)
- RADIUS-3**
Radius bend set up charge (Under 3' Radius)
- R-UNITS**
Radius unit charge, Per 8' Max length
- AC-RADIUS**
Internal Bracket (Standard Channel)

Factory Miters

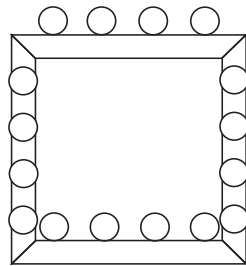

NOTE: Dimensional drawings with lamp orientation required.

AC-MITER

- Factory Miter Cut
- Standard Profile